

Original BMW Accessories.

Installation Instructions.



M Performance tailgate silencer system retrofit kit BMW M2 (F87)

Retrofit kit number

18 30 2 412 432 M Performance tailgate silencer system F87

Installation time

The installation time is **approx. 2.0 hours**. This may vary depending on the condition of the vehicle and the equipment in it.

Important information

These installation instructions are primarily designed for use within the BMW dealership organisation and by authorised BMW service companies.

These installation instructions are intended for use by qualified specialist staff trained on BMW vehicles with the relevant expert knowledge.

All work must be completed using the latest BMW repair manuals, wiring diagrams, servicing manuals and work instructions, in a rational order, using the prescribed tools (special tools) and observing current health and safety regulations.

If you experience installation or function problems, restrict troubleshooting to approx. 0.5 hours for mechanical work and 1.0 hour for electrical work.

To avoid unnecessary extra work and/or costs, send an inquiry straight away to the technical parts support team via the Aftersales Assistance Portal (ASAP).

Quote the following information:

- Chassis number,
- Retrofit kit part number,
- A detailed description of the problem,
- and any work already carried out.

Do not archive the hard copy of these installation instructions since daily updates are provided via ASAP.

Pictograms



Denotes instructions that draw your attention to dangers.



Denotes instructions that draw your attention to special features.



Denotes the end of the instruction or other text.

Installation information

Ensure that the cables and/or lines are not kinked or damaged as you install them in the car. Costs arising from this will not be reimbursed by BMW AG.

Additional cables/wires that you install, must be secured with cable ties. If the specified PIN chambers are occupied, bridges, double crimps, or twin-lead terminals must be used.

All pictures show LHD cars; proceed accordingly on RHD cars.

Check that all the parts fit accurately on the car before fitting them.

Some of the installation steps are shown only on one side of the car. Proceed in the same way on the other side of the car.

Workshop certificate

Print out the workshop certificate at the end of the installation instructions, fill it in and give it to the customer.

 **The use of “Track Mode” on public roads nullifies the vehicle registration. ◀**

Radio remote control

Tailgate silencer remote control **G** must be given to the customer along with its packaging and its function explained.

Special tools required

17 2 051, no information

Table of contents

Chapter	Page
1. M Performance tailgate silencer system parts list	4
2. Preparatory work	5
3. Installing the M Performance tailgate silencer system	6
4. Concluding work and coding	9
5. Workshop certificate	10

1. M Performance tailgate silencer system parts list

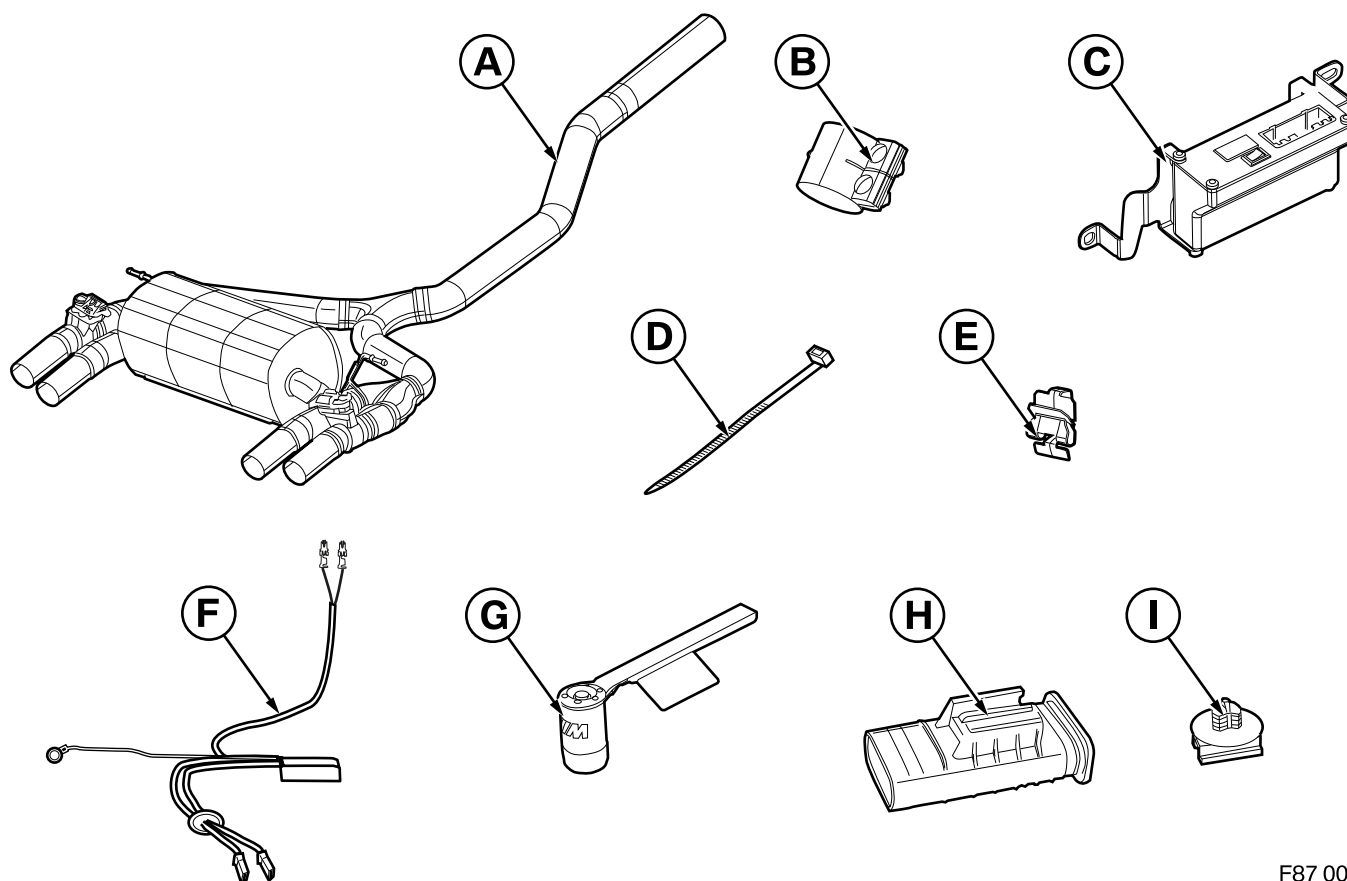

F87 0052 V

Legend

- A** Tailgate silencer
- B** Clamp
- C** Tailgate silencer receiver unit
- D** Cable ties (5 x)
- E** Cable clip (6 x)
- F** Tailgate silencer wiring harness
- G** Tailgate silencer remote control (including packaging)
- H** Dummy flap actuator
- I** Retaining clip

2. Preparatory work

	ISTA No.
Disconnect the negative pole of the battery	12 00 ...
The following components must be removed first of all	
Cut the exhaust system at the centre silencer service separation point (centrepunch point) using suitable tools and then remove the tailpipe	---
Boot floor	---

3. Installing the M Performance tailgate silencer system

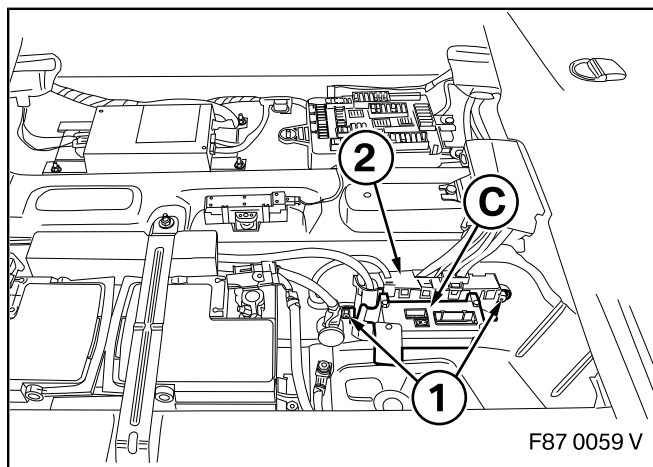

Screw tailgate silencer receiver unit **C** using both nuts (1) to the distributor (2) in the boot floor.

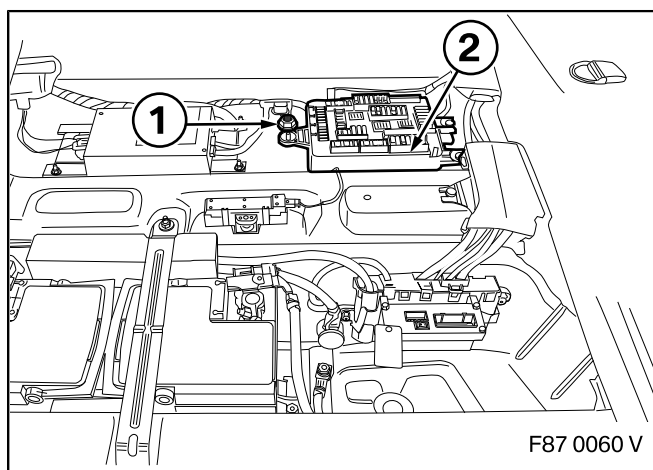

Remove the nuts (1) on the fuse holder (2) in the boot floor. Lever out the fuse holder (2).

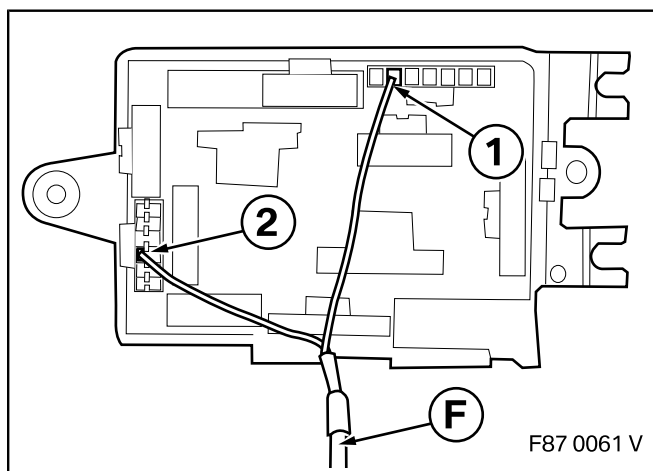

Connect the green cable (1) from tailgate silencer wiring harness **F** to the plug of fuse **F1371**.

Connect the red cable (2) from tailgate silencer wiring harness **F** to the plug of fuse **F145**.

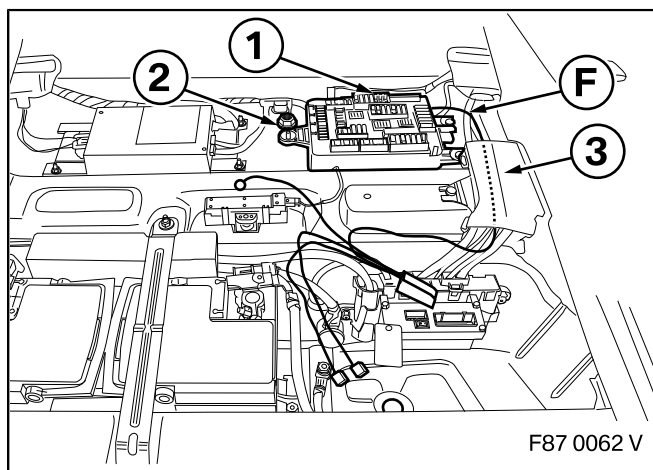

Fit the fuse holder (1) again, routing the tailgate silencer wiring harness **F** to the side. Tighten the nut (2). Route the tailgate silencer wiring harness **F** under the cover (3).

3. Installing the M Performance tailgate silencer system

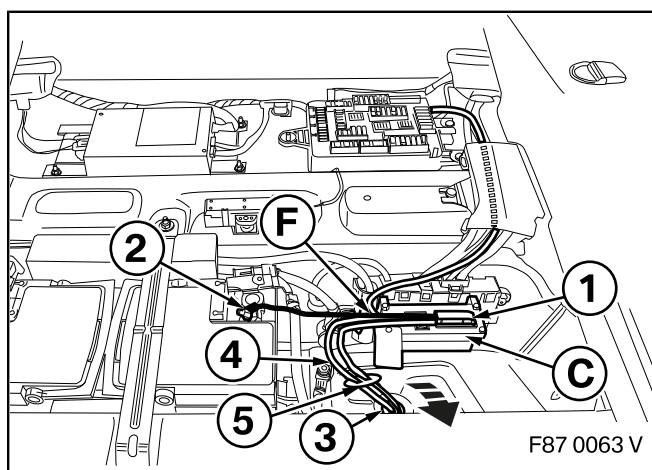

Insert the large plug on tailgate silencer wiring harness **F** into the large socket (1) on tailgate silencer receiver unit **C**. Screw the small cable to the earth post (2). Remove the sealing plug for the opening (3) from the boot tray. Thread the two tailpipe silencer plugs (4) through the opening (3) and attach the rubber bung (5) from tailpipe silencer wiring harness **F**.

Secure the cables to the existing cables at a suitable point using a cable tie **D**. ◀

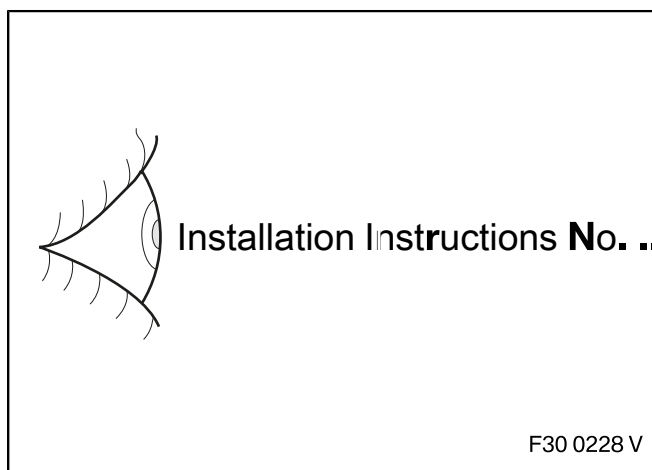

Install the dummy valve adjuster **H** as described in **Installation Instructions No. 01 29 2 412 923**.

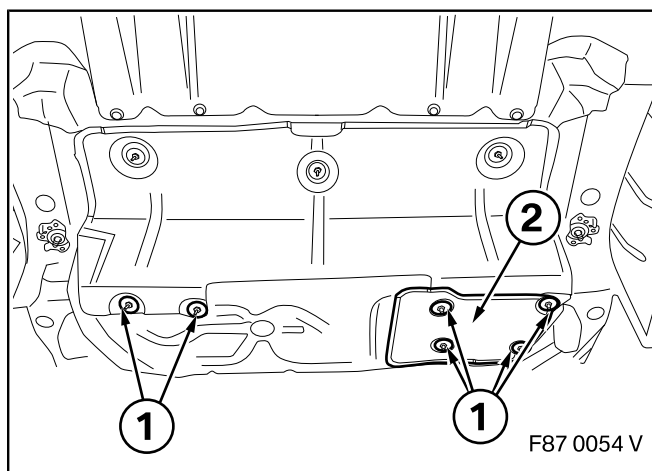

Remove the self-tapping nuts (1). Remove all the heat insulation (2).

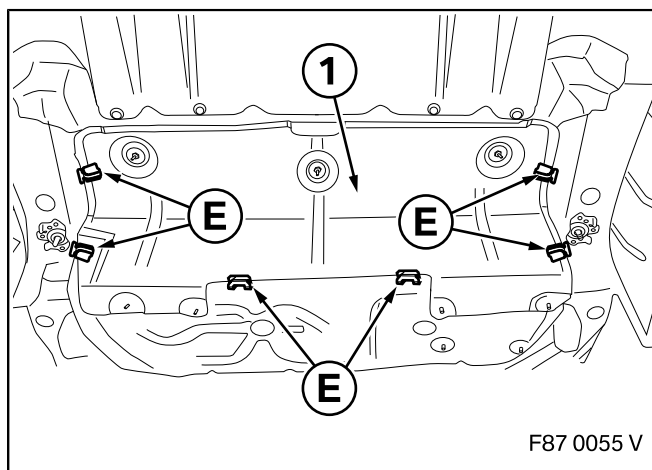

Attach the six cable clips **E** to the edge of the heat insulation (1) as shown.

3. Installing the M Performance tailgate silencer system

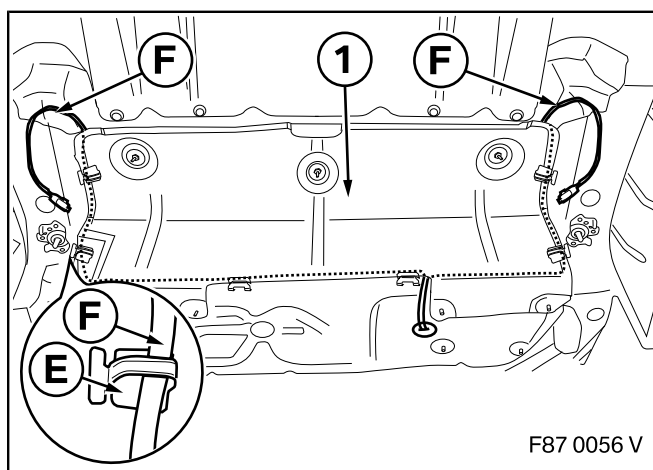

Route tailpipe silencer wiring harness **F** along the edge **above** the heat insulation (1) and secure it in the cable clips **E**.

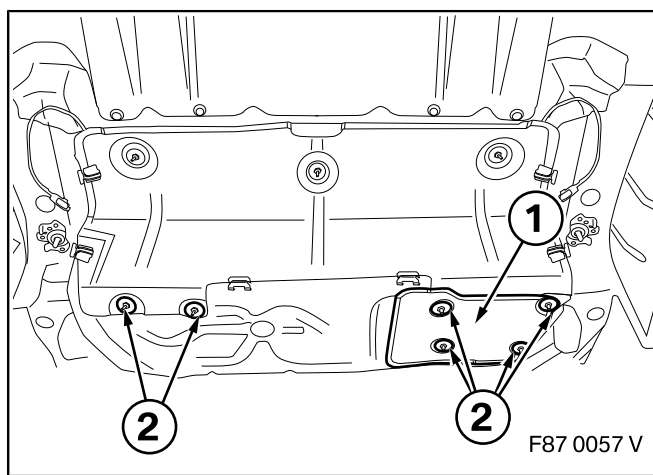

Fit the heat insulation (1) and tighten the self-tapping nuts (2).

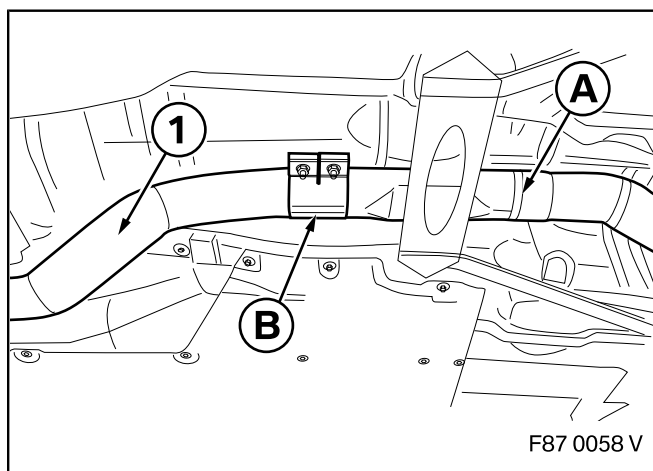

Use the retaining rubbers for the standard exhaust system and slide them onto the tailpipe silencer **A**. ◀

Slide the clamp **B** onto the existing centre pipe (1). Slide the end of the tailpipe silencer **A** into the clamp **B**. Align the clamp **B** as shown and installed the tailpipe silencer **A** as described in **ISTA**. Tighten the clamp **B** with a torque of **55 Nm**.

Connect the plugs on the tailgate silencer wiring harness **E** to the two valve adjusters on the rear silencer.

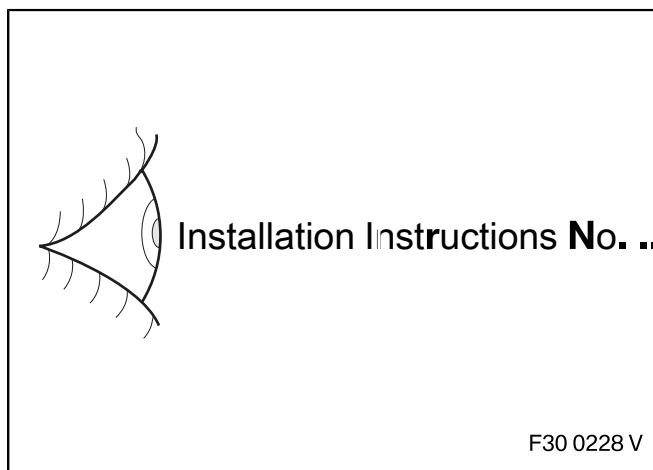

Then fit tailpipe finisher as described in **EBA No. 01 29 2 287 618**.

4. Concluding work and coding

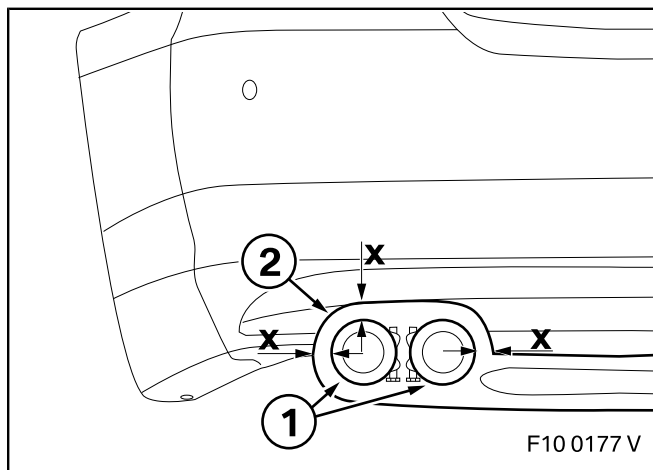

▶ The exhaust pipe finishers (1) must be aligned centrally and parallel to the contour (2) and must not project beyond the bodywork parts above them. ◀

- This retrofit does not require coding
- Re-assemble the car
- Conduct a brief test

5. Workshop certificate



Workshop certificate M Performance Tailgate silencer system

This is to confirm that the M Performance tailgate silencer system has been fully installed on the vehicle below.
No additional components have been converted or retrofitted.

Part number

18 30 2 412 432

M Performance tailgate silencer system

F87

The use of “Track Mode” on public roads nullifies the vehicle registration.

Car model:

Vehicle identification no.:

Name and address of the vehicle owner:

Place, date

Signature of person responsible

Dealership (company name / stamp)